

MMI

**BOARD TO BOARD
PITCH: 0.80mm**

0.80mm BOARD TO BOARD - SURFACE MOUNT TYPE - Pt

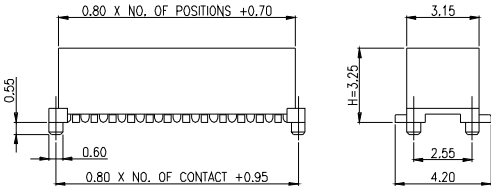
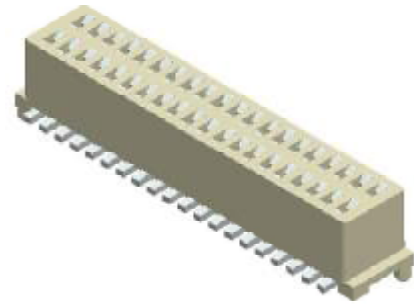
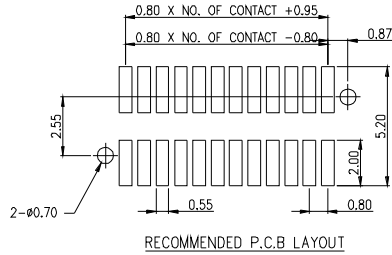
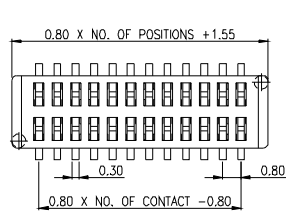

BTBf003-F

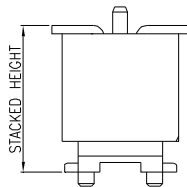
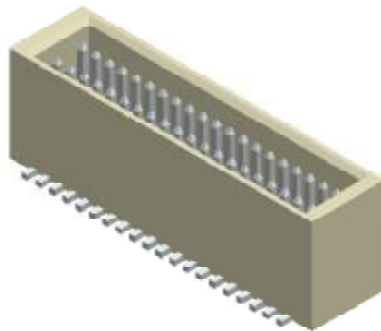

STACKED HEIGHT	GENDER	PART NO.	H
5.5mm	MALE	BTBf003A-PtMXXT-X	4.32
	FEMALE	BTBf003A-PtFXXT-X	3.25
7.0mm	MALE	BTBf003B-PtMXXT-X	5.85
	FEMALE	BTBf003A-PtFXXT-X	3.25

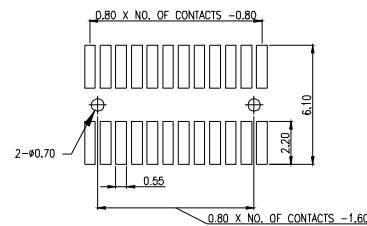
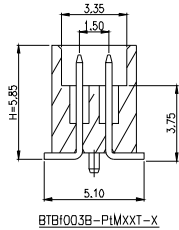
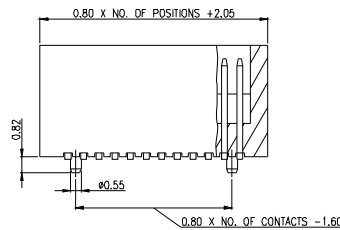
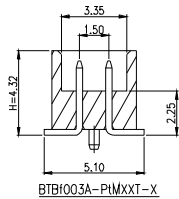
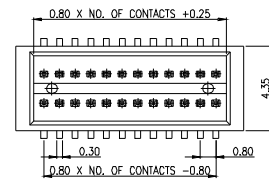

BTBf003-M

BTB	f	003	X	Pt	X	##	T	X
BOARD TO BOARD	PITCH f: 0.80 mm	SERIES NO.	STACKED HEIGHT A: 5.50mm B: 7.00mm	PCB TYPE Pt: SURFACE MOUNT TYPE	GENDER M: MALE F: FEMALE	NO. OF PINS 2X5 ~ 2X50	CONTACT PLATING T: TIN PLATING	PACKAGE TYPE BLANK: TUBE T/R: TAPE & REEL (PLEASE CONTACT FACTORY FOR AVAILABLE NO. OF PINS)

SPECIFICATIONS

CONTACT RATING: 0.5 AMPS
 INSULATOR RESISTANCE: 1000Ω MIN.
 DIELECTRIC WITHSTANDING: AC 150V
 OPERATING TEMPERATURE: -40°C~+105°C

MATERIALS

CONTACT MATERIAL: COPPER ALLOY
 INSULATOR MATERIAL: THERMOPLASTIC, UL 94V-0
 FINISH: TIN PLATED

NOTE : SOME SIZES, STYLES AND OPTION ARE NON-STANDARD, NON-CANCELLABLE, NON-RETURNABLE